

My First Music Maker

User's Manual

BATTERY INSTALLATION

1. Make sure the unit is turned OFF.
2. Locate the battery cover on the bottom of the unit. Use a coin or a screwdriver to loosen the screw.
3. Install 2 new 'AA' (AM-3/LR6) batteries following the diagram inside the battery box. (The use of new alkaline batteries is recommended for maximum performance.)
4. Replace the battery cover and tighten the screw to secure.

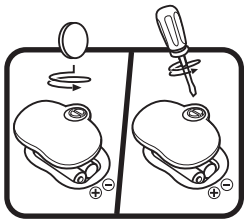



BATTERY NOTICE

- The use of new alkaline batteries is recommended for maximum performance.
- Non-rechargeable batteries are not to be recharged.
- Rechargeable batteries are to be removed from the toy before being charged (if removable).
- Rechargeable batteries are only to be charged under adult supervision (if removable).
- Different types of batteries or new and used batteries are not to be mixed.
- Only batteries of the same or equivalent type as recommended are to be used.
- Batteries are to be inserted with the correct polarity.
- Exhausted batteries are to be removed from the toy.
- The supply terminals are not to be short-circuited.
- The toy is not to be connected to more than recommended number of power supplies.
- Do not dispose of batteries in fire.

WE DO NOT RECOMMEND THE USE OF RECHARGEABLE BATTERIES.

PRODUCT FEATURES

1. ON/OFF/VOLUME CONTROL SWITCH

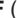

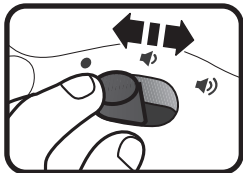
To turn the unit **ON**, slide the **ON/OFF/VOLUME CONTROL SWITCH** to the **LOW VOLUME** () or **HIGH VOLUME** () position. To turn the unit **OFF**, slide the **ON/OFF/VOLUME CONTROL SWITCH** to the **OFF** () position.



2. AUTOMATIC SHUT-OFF

To preserve the battery life, the **VTech® My First Music Maker** will automatically power-down after approximately 30 seconds without input. The unit can be turned on again by pressing any button.

ACTIVITIES

1. Slide the **ON/OFF/VOLUME CONTROL SWITCH** to the **LOW VOLUME** () or **HIGH VOLUME** () position to turn the unit on. You will hear an entertaining sing along song, an amusing phrase and fun melodies. The light will flash with the sound.

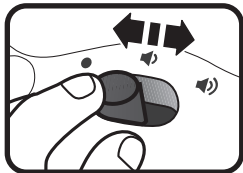

2. Press any of the three **instrument buttons** to hear the instruments name, fun phrases, sound effects and melodies played by the relevant instrument. While the melodies are playing press another instrument button to change the selected instrument. The drum and cymbals can be played over the melodies and the tempo can be changed by twisting the disc. The light will flash with the sound.

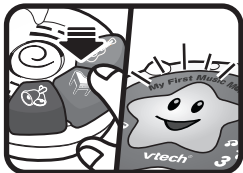

3. Press the **light-up star button** to hear fun phrases, drum sounds and learn numbers 1-2-3. While a melody is playing, press the light-up star button to hear drum sounds over the melodies. The light will flash with the sound.

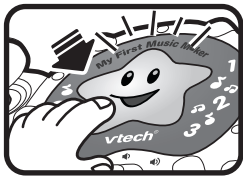

4. Wobble the **cymbal button** to hear cymbal sound effects and a fun sing along song. While a melody is playing, press the **cymbal button** to hear cymbal sounds over the melodies. The light will flash with the sound.

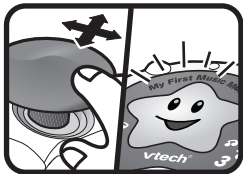

5. Twist the **turning disc** to hear fun phrases, sound effects and melodies. Once a melody is playing use the disc to speed up and slow down the tempo. The light will flash with the sound.

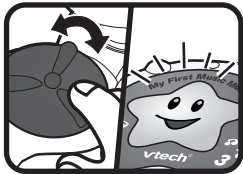

MELODY LIST

- | | |
|------------------------|--------------------|
| 1. ABC's Alphabet Song | 4. Old MacDonald |
| 2. Hey Diddle Diddle | 5. Twinkle Twinkle |
| 3. Farmer in the Dell | 6. Mulberry Bush |

CARE AND MAINTENANCE

1. Keep the unit clean by wiping it with a slightly damp cloth.
2. Keep the unit out of direct sunlight and away from any direct heat source.
3. Remove the batteries when the unit is not in use for an extended period of time.
4. Do not drop the unit on hard surfaces and do not expose the unit to moisture or water.

TROUBLESHOOTING

If for some reason the program/activity stops working or malfunctions, please follow these steps:

1. Please turn the unit **OFF**.
2. Interrupt the power supply by removing the batteries.
3. Let the unit stand for a few minutes, then replace the batteries.
4. Turn the unit **ON**. The unit should now be ready to play again.
5. If the product still does not work, replace with a new set of batteries.

If the problem persists, please call our Consumer Services Department on 01235 546810 (from UK) or +44 1235 546810 (outside UK) and a service representative will be happy to help you.

NOTE: Please keep instruction manual as it contains important information.

